

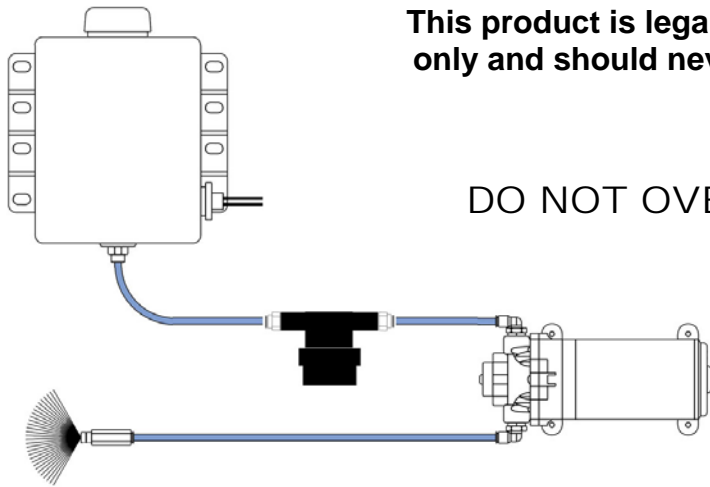

Part Number 30-3003  
Water/Methanol Injection Filter

**This product is legal in California for racing vehicles only and should never be used on public highways.**



**DO NOT OVERTIGHTEN FITTINGS!**

1. Install fittings into filter housing. No additional sealant is required. Turn until just finger tight and then tighten 1 ½ to 2 additional turns by wrench. **DO NOT OVERTIGHTEN!** Cracked filter housings will **NOT** be covered under warranty!
2. Install filter on the low pressure side between the tank and pump. Splice into existing line by cutting tubing with a sharp razor blade. Install filter with arrow on housing pointing in the direction of flow.
3. Ensure removable filter bowl is tight. Prime injection system and check for leaks.
4. Check that filter does not contact any hot or moving parts.
5. Filter will protect injection system from foreign particles and small debris down to 40 microns in size. Periodically inspect and clean the filter element for longest service life.

### **Important Safety Notice Regarding Methanol**

**AEM strongly recommends that users never exceed a 50% methanol concentration when using any AEM Water Methanol system or component.**

All AEM Water/Meth injection systems and components (pump, lines, fittings, filter, flow sensor, tank, and nozzles) are 100% chemically compatible with methanol. However, for safety reasons we strongly recommend that users never use more than a 50% methanol concentration in our systems.

Methanol is a toxic and highly flammable chemical. 100% Methanol ignites easily and burns vigorously with an almost undetectable flame. Methanol can be absorbed through the skin and even small amounts can cause blindness or even death. Using this fluid at high pressures, without dilution, in an under-hood environment with nylon lines and push-to-connect fittings is very unsafe. The performance advantages of using greater than 50% methanol concentrations are small, if they exist at all. However, the safety issues are very real and far out weigh any perceived benefit of running high concentrations of methanol.

**Note: AEM holds no responsibility for any engine damage or personal injury that results from the misuse of this product, including but not limited to injury or death caused by the mishandling of methanol.**